

Exhibit C

ADA POPULATION 1940—15,143
Altitude—1,000 Feet
Assessed Valuation Gross 1941—\$5,513,204.
Less Homestead Exemptions—\$1,212,380.
Net City Assessed Valuation—\$4,300,824.
Bonded Indebtedness—1941—\$664,250.
1941 Tax Rate \$58.58 per \$1,000.
Light Meters 1942—3,950 Est.
Gas Meters 1942—4,000 Est.
Telephones 1942—3,139 Est.
Water Meters 1942—3,701 Est.

SCHOOLS

Seven Ward Schools
Two Senior High Schools
Two Junior High Schools
East Central State College
One High School for Colored
Three Large City Parks

INDUSTRIES

Oklahoma Portland Cement Company
Hazel-Atlas Glass Co.
Ada Milling Co.
Peoples Cotton Compress Company.
Wickham Packing Co.
Cudahy Packing Co.
Thomas Concrete Pipe Co.
Ada Mattress Factory
Allen Feed Mills
Three Wholesale Houses
Three Ice Plants
Dri-Ice Plant
Ada Lime Company

ADA IS SERVED BY:

The Frisco, Santa Fe and O.C.A.&A. Railroads,
Luper and Couch Freight Lines
54 Daily Bus Schedules
City Bus Lines with 64 Daily Schedules
Highways—No. 3, 12, 13, 19, and 99.

The Following Companies Service Ada:

Southwestern Bell Telephone Company
Southwest Gas Company
Oklahoma Gas & Electric Company

Ada's Water supply is furnished from the famous Byrds Mills Springs, sufficient for a city of 50,000 people.

One Daily Newspaper and Two Weeklies

Many Fine Churches

KADA Radio Station and NBC Blue Network.

PONTOTOC COUNTY

Area—728 Square Miles

Population 1940—39,792

Population in 25-mile Radius 1938—88,446

Population in 25-mile Radius 1940—115,000 Est.

Miles State Highway—117.12

Assessed Valuation Gross 1941—\$17,092,905.00

Less Homestead Exemptions — 2,300,985.00

Net County Assessed Valuation—14,791,920.00

Bonded Indebtedness 1941—\$477,289.12

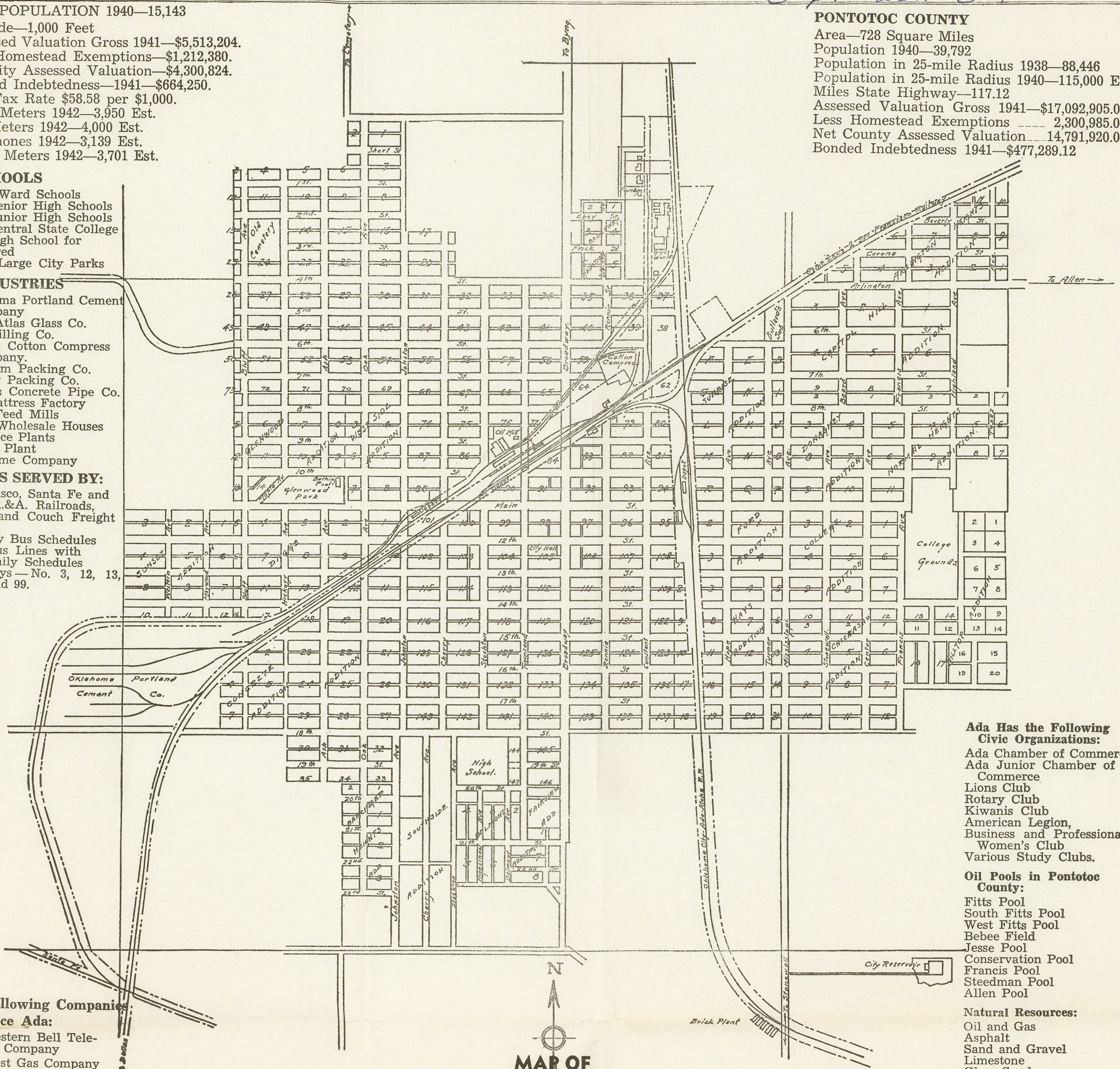

Ada Has the Following Civic Organizations:

Ada Chamber of Commerce,
Ada Junior Chamber of Commerce
Lions Club
Rotary Club
Kiwanis Club
American Legion,
Business and Professional Women's Club
Various Study Clubs.

Oil Pools in Pontotoc County:

Fitts Pool
South Fitts Pool
West Fitts Pool
Beebe Field
Jesse Pool
Conservation Pool
Francis Pool
Steedman Pool
Allen Pool

Natural Resources:

Oil and Gas
Asphalt
Sand and Gravel
Limestone
Glass Sand
Building Stone
Shales
Dairying
Cattle
Corn
Cotton
Oats
Peanuts
Pecans

MAP OF

Ada, Oklahoma

By Ada Chamber of Commerce